

SPARE PARTS EXPLODED VIEW
STORAGE ELECTRIC WATER HEATERS

Model

TI-SHAPE PL

R8215514-01EN - Edition 01 - 21/07/2006

310 0026		TI-SHAPE 10 OR PL
310 0027		TI-SHAPE 10 UR PL
310 0028		TI-SHAPE 15 OR PL
310 0029		TI-SHAPE 15 UR PL
310 0030		TI-SHAPE 30 R PL
Reference	Ind.	Model type	Begin	End

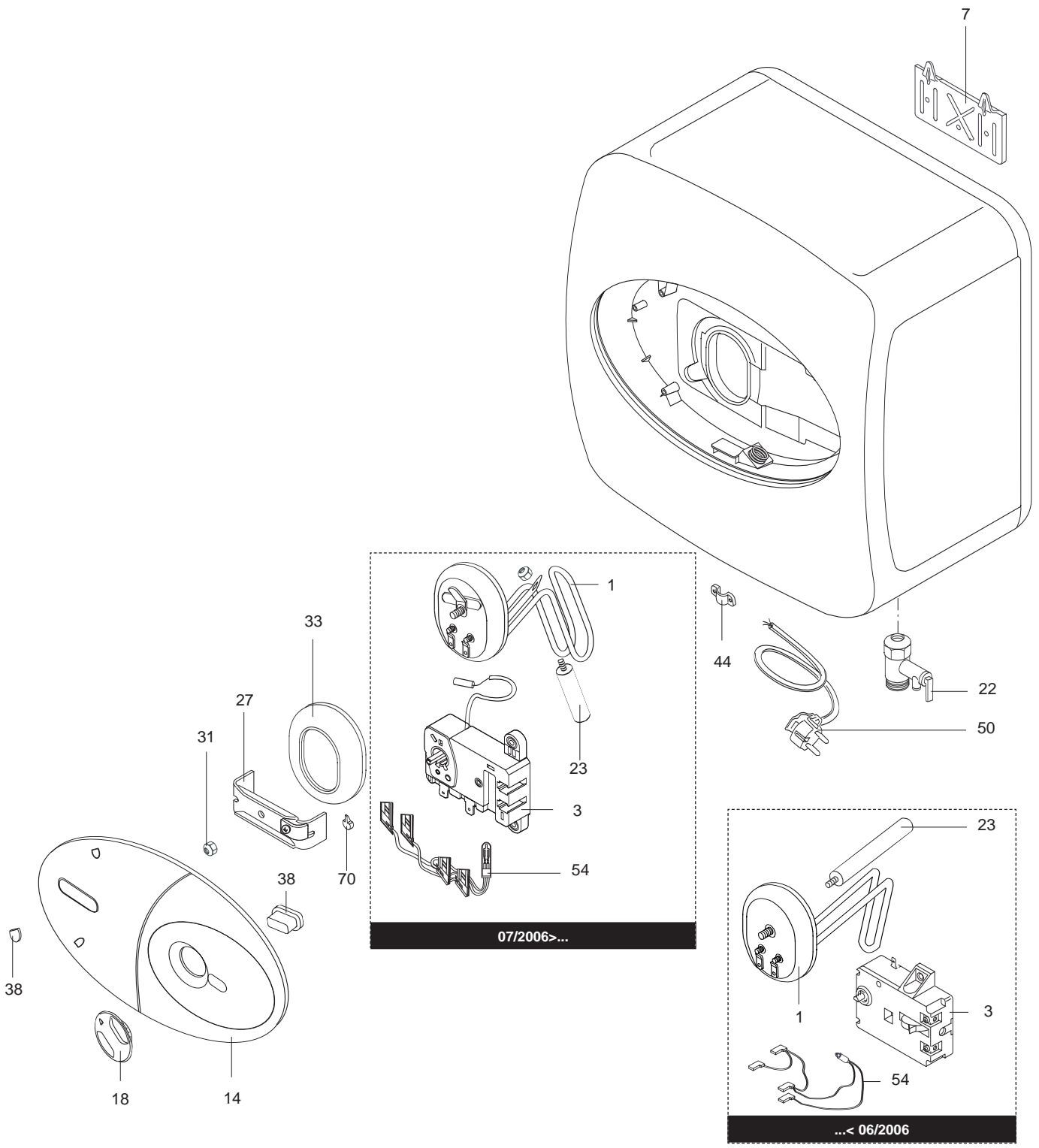

Key N	Description	Manf. Pt. N	Other	Type				Manf. date	
					10	15	30	from	to
0001	ELEMENT 1500W 220-240V	65103766			•	•	•	07/06	
	ELEMENT 1500W 220-240V	990966					•		06/06
	ELEMENT 1500W 220-240V	990967			•	•			06/06
0003	THERMOSTAT	65101079					•		06/06
	THERMOSTAT	65102365			•	•			06/06
	THERMOSTAT	65103771			•	•	•	07/06	
0007	HEATER WALL HANGING BRACKET	570341			•	•	•		
0014	PLASTIC COVER	65100872					•		05/04
	PLASTIC COVER	65102518			•	•			
	PLASTIC COVER	65102518					•	06/04	
0018	KNOB	65100875			•	•	•		
0022	SAFETY VALVE	571730			•	•	•		
0023	ANODE D.15 L:210 M5	570241					•		06/06
	ANODE D.13,8 L:150 M5	574305			•	•			06/06
	ANODE D:21,3 L:110	65103768					•	07/06	
	ANODE D:21,3 L:80	65103793			•	•		07/06	
0027	FLANGE BRACKET	570024			•	•	•		
0031	NUT M6	570069			•	•	•		
0033	FLANGE GASKET	65100282			•	•	•		
0038	SWITCH COVER	65100873			•	•	•		
	SCREW COVER	65100874			•	•	•		
0044	CABLE CLAMP	573266			•	•	•		
0050	CABLE (POWER SUPPLY)	570096			•	•	•		
0054	WIRING	570077			•	•	•		06/06
	WIRING	65104037			•	•	•	07/06	
0070	CAP (REGULATION)	570029			•	•	•		

LIST OF THE ABBREVIATIONS

HW	: Hot water.
CW	: Cold water.
C	: Ceramic resistance (normal heating).
Ca	: Ceramic resistance (accelerated heating)
TP	: Immersion heater.
1F	: With fittings.
2F	: Without fittings.
3F	: With fittings and another outlet connection.
AMI	: With mixing valve.
SMI	: Without mixing valve.
PUISS	: Power of th appliance.
PN	: Appliance with normal pression.
LP	: Appliance with low pression.
PV	: Appliance with variable power.
PF	: Appliance with fixed power..

IDENTIFICATION PLATE

SERIAL NUMBER

Ex: 03 09 08

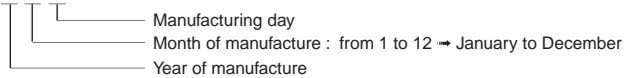

Manufacturing day
 Month of manufacture : from 1 to 12 → January to December
 Year of manufacture

OR

Ex: 02 11 00001 007843

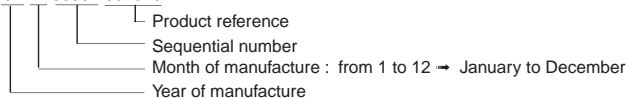

Product reference
 Sequential number
 Month of manufacture : from 1 to 12 → January to December
 Year of manufacture

The indications mentioned on the prices, commercial or technical literature and the scheme are written for your guidance and are available at a given time. The CONSTRUCTOR retains the power to modify the presentation, the form, the size, the conception or the material of the products.